

PITCHED ROOF ABUTMENT

Remove sufficient rows of tiles/slates and battens and turn back the undertile membrane.

Apply an 18mm Plywood or OSB/3 timber infill to the bottom of the pitched roof, notched into & mechanically fastened to the rafters of sufficient dimensions to achieve a minimum 150mm vertical height waterproofing upstand above the finished roof level.

Apply sufficient coats of the specified BÖRNER PRIME COATING to the detail.

Apply the specified BÖRNER Vapour Control Layer to the primed substrate & dressed to link with the Underlayer by 50mm minimum.

Apply the specified PIR Insulation to the Vapour Control Layer, to be bonded as per BÖRNER Specification Proposal.

Apply the specified waterproofing detailing fully bonded to the detail. Detailing Underlayer and Cap Sheet must be lapped and fully sealed onto the main area as indicated.

On completion of the detailing works provide a tilting fillet beneath the bottom tile as indicated and re-dress the undertile membrane and re-fix tiling battens and tiles/slates to provide 75mm minimum cover to the new waterproofing.

NOTES:

Where torch applied abutment details are deemed to be inappropriate following the Client/ Contractor's Risk Assessment for the works, BÖRNER recommend that materials designed to be installed by using flame-free application techniques are used.

All details to be installed in accordance with BS8217, BS6229, and BÖRNER recommendations.

All waterproofing detailing must be undertaken as two layers and as separate items.

All surfaces must be clean, dry, and suitably prepared to accept the waterproofing system.

During the application of all bitumen membranes a visible bead of bitumen must be exuded from all side and end laps.

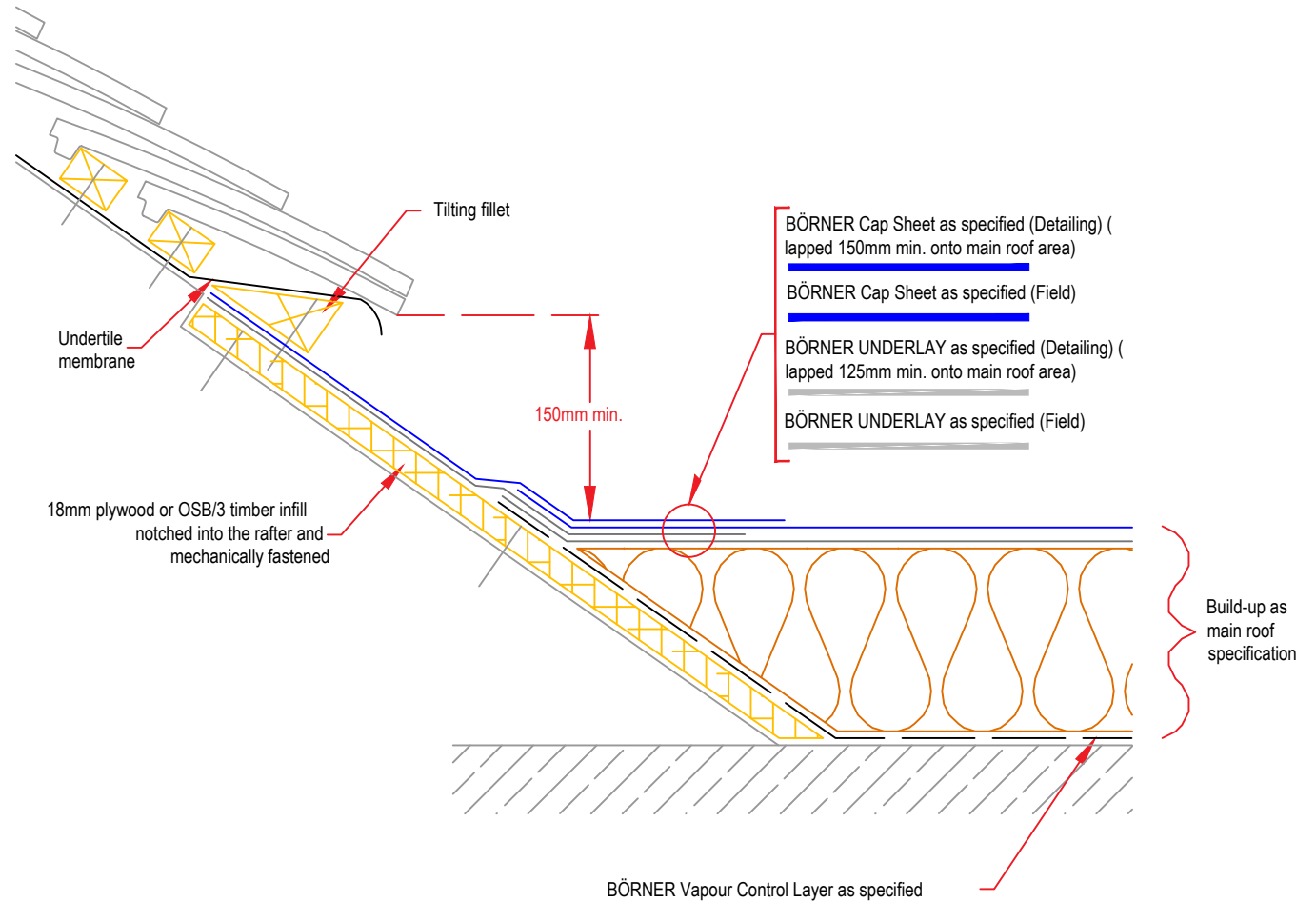

Copyright Reserved - Please note that this drawing & the copyright therein is the property of BÖRNER & is issued on the understanding that the drawing or any detail thereof will not be divulged to a third party unless written permission is first obtained from BÖRNER technical services department. The drawing is valid only when approved by the Architect / Contractor concerned.

This detail is representative of a typical situation and provided for illustration purposes. Insulation thickness shown may differ in accordance with specifier's U value requirement.

Standard Detail

Drawing Title:

Pitched Roof Abutment

Date:
2018

Notes / Revisions:

Drawing No.

L1

Scale:
NTS

Drawn By:
BÖRNER



BÖRNER. Systematically sealed.

Email: info@borner.ie