

EXPANSION KERB - Built Kerbs

Remove the existing capping & all associated components as necessary.

Inspect & carry out any necessary maintenance work to any existing kerbs.

Provide or raise the upstand kerbs as necessary with timber sections of appropriate dimensions to achieve a minimum 150mm upstand height from the finished roof level as indicated.

The expansion gap between the upstand kerbs should be filled with a compressible sealant.

Apply an 18mm Plywood or OSB/3 timber capping, securely fastened to one of the kerbs only extending over the other kerb to allow for the application of a GRP edge trim.

Apply sufficient coats of the specified BÖRNER PRIME COATING to the detail.

Apply the specified BÖRNER Vapour Control Layer to the primed upstand & dressed to link with the Underlayer by 50 mm minimum.

Apply the specified PIR Insulation to the Vapour Control Layer, to be bonded as per BÖRNER Specification Proposal.

Provide 50mm x 50mm specified BÖRNER Angle Fillets to the junction of all horizontal & vertical abutments

Apply the specified waterproofing detailing fully bonded to the vertical and horizontal surfaces of the detail, lapped and fully sealed onto the main area as indicated. The specified BÖRNER Underlay (Detailing) should be finished so as to drape over the outer edge as shown.

Apply GRP edge trim, mechanically fastened to the timber capping at 300mm centres maximum (150mm maximum for areas of high wind uplift) and sandwiched between waterproofing layers as indicated. Apply specified BÖRNER Cap Sheet (Detailing) fully bonded to the vertical and horizontal surfaces of the detail, dressed into the channel of the GRP edge trim, lapped and fully sealed onto the main roof area as indicated.

NOTES:

All details to be installed in accordance with BS8217, BS6229, and BÖRNER recommendations.

All waterproofing detailing must be undertaken as two layers and as separate items.

All surfaces must be clean, dry, and suitably prepared to accept the waterproofing system.

During the application of all bitumen membranes a visible bead of bitumen must be exuded from all side and end laps.

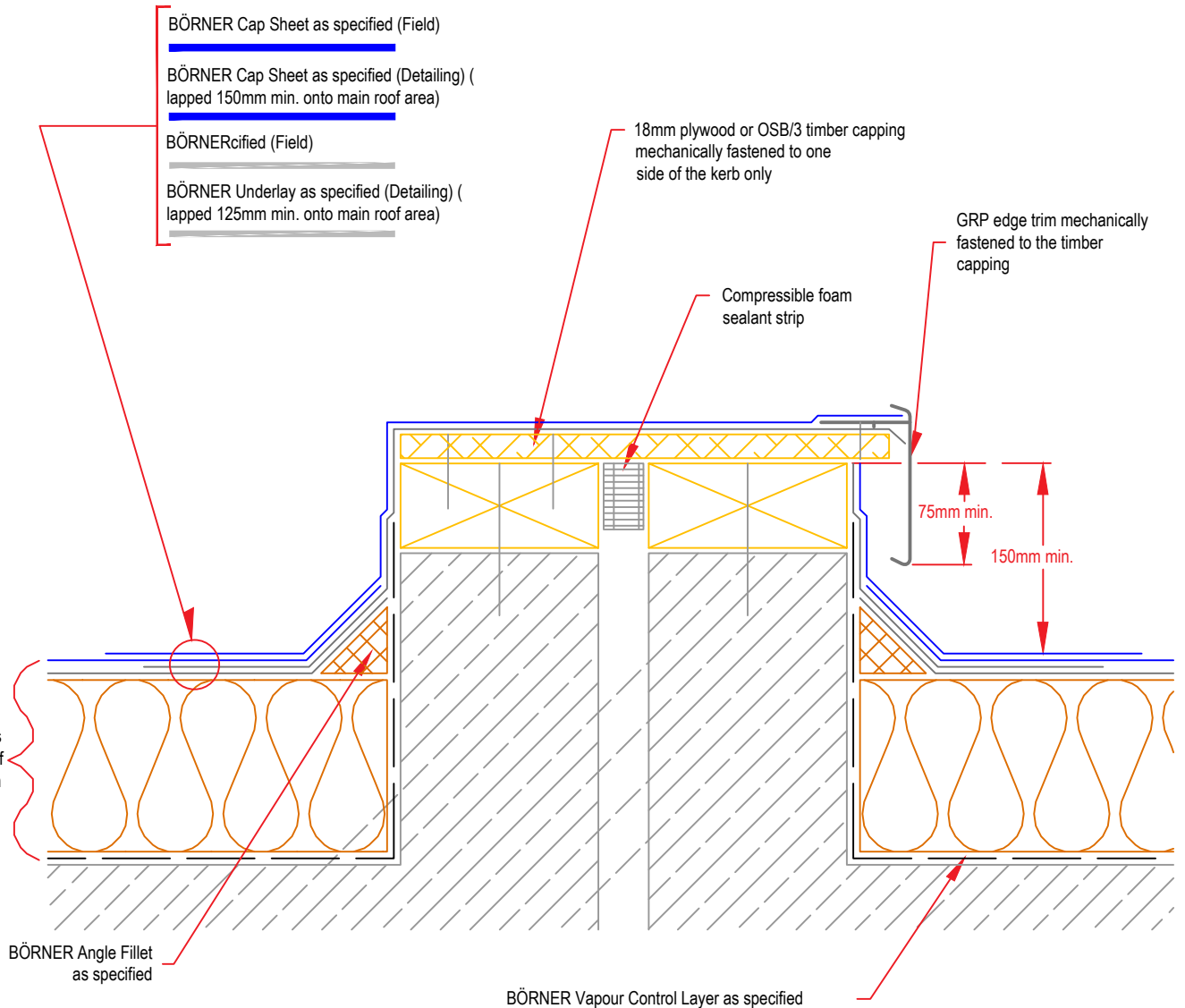

Standard Detail

Copyright Reserved - Please note that this drawing & the copyright therein is the property of BÖRNER & is issued on the understanding that the drawing or any detail thereof will not be divulged to a third party unless written permission is first obtained from BÖRNER technical services department. The drawing is valid only when approved by the Architect / Contractor concerned.

This detail is representative of a typical situation and provided for illustration purposes. Insulation thickness shown may differ in accordance with specifiers U value requirement.

Drawing Title:

Expansion Kerb - Built Kerbs

Date:
2018

Notes / Revisions:

Drawing No.

J2

Scale:
NTS

Drawn By:
BÖRNER



BÖRNER. Systematically sealed.

Email: info@borner.ie