

INTERNAL GUTTER - Gutter within Deck

Option 1

Apply treated timber stop battens throughout the full length to the top edges of the gutter (100mm wide & 10mm thinner than the insulation, so as to prevent lap build up) or Insulated Hard Edge mechanically fixed to the roof deck, to provide a hard edge to all gutter steps.

Apply sufficient coats of the specified BÖRNER PRIME COATING to the detail.

Apply the specified BÖRNER Vapour Control Layer to the primed substrate & dressed to link with the Underlayer by 50mm minimum.

Apply the specified PIR Insulation to the Vapour Control Layer, including to the gutter, to be bonded as per BÖRNER Specification Proposal.

Provide 50mm x 50mm specified BÖRNER Angle Fillets as indicated.

Apply the specified waterproofing detailing fully bonded to the full width and length of the gutter as indicated.

Apply a sacrificial layer of Cap Sheet to run the length of the sole of the gutter to reduce lap build up.

Option 2

Apply sufficient coats of the specified BÖRNER PRIME COATING to the detail.

Apply the specified BÖRNER Vapour Control Layer to the primed substrate & dressed to link with the Underlayer by 50mm minimum.

Apply the specified PIR Insulation to the Vapour Control Layer, including to the gutter, to be bonded as per BÖRNER Specification Proposal.

Apply a galvanised metal angle minimum 150mm x 150mm, bonded in BÖRNER PU ADHESIVE to protect the exposed corner of the insulation as indicated.

Provide 50mm x 50mm specified BÖRNER Angle Fillets as indicated.

Apply the specified waterproofing detailing fully bonded to the full width and length of the gutter as indicated.

Apply a sacrificial layer of Cap Sheet to run the length of the sole of the gutter to reduce lap build up.

NOTES:

All details to be installed in accordance with BS8217, BS6229, and BÖRNER recommendations. All waterproofing detailing must be undertaken as two layers and as separate items.

All surfaces must be clean, dry, and suitably prepared to accept the waterproofing system

During the application of all bitumen membranes a visible bead of bitumen must be exuded from all side and end laps.

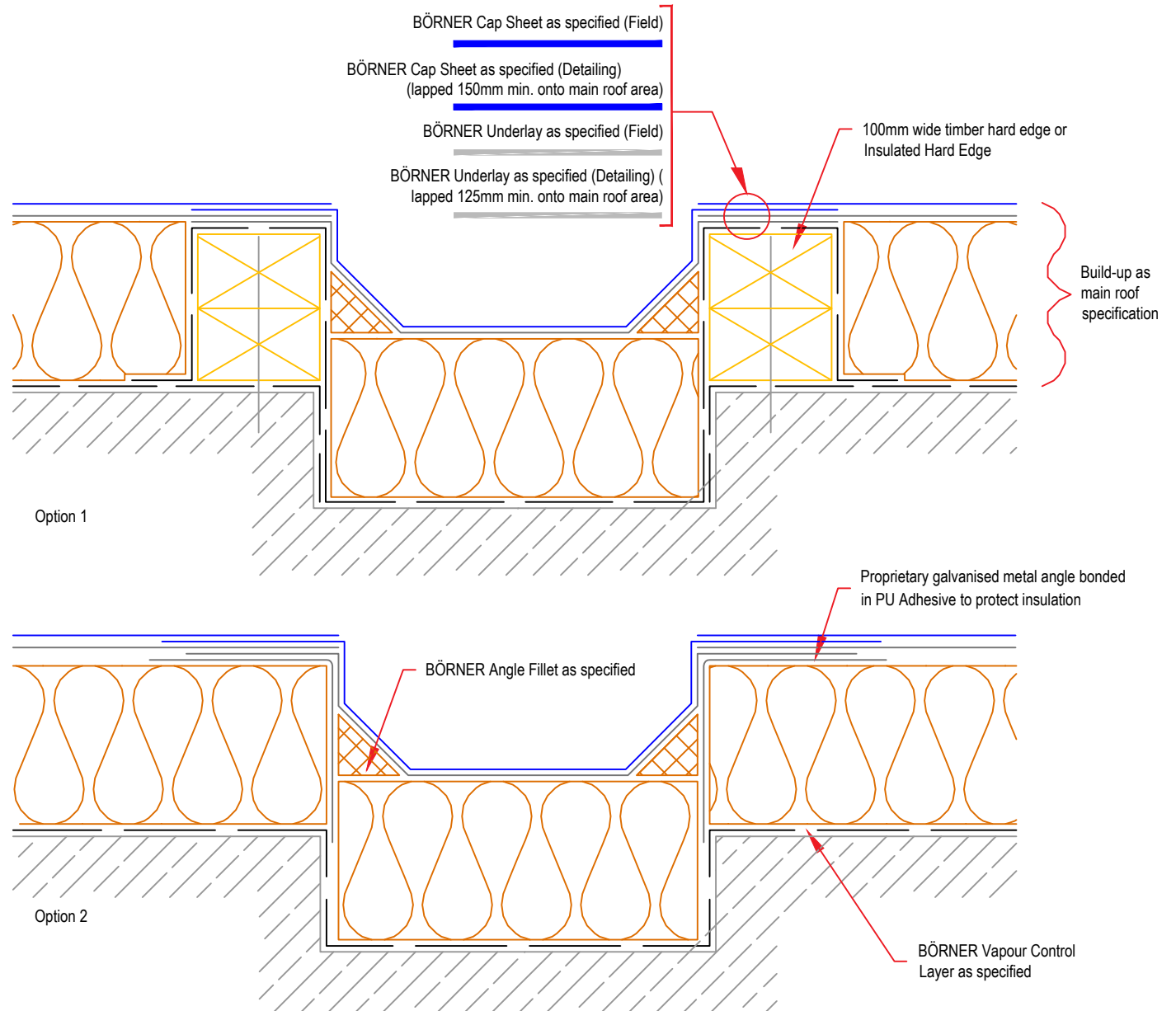

Standard Detail

Drawing Title:

Internal Gutter - Gutter within Deck

Date:
2018

Notes / Revisions:

Drawing No.

G5

Scale:
NTS

Drawn By:
BÖRNER



BÖRNER. Systematically sealed.
Email: info@borner.ie

Copyright Reserved - Please note that this drawing & the copyright therein is the property of BÖRNER & is issued on the understanding that the drawing or any detail thereof will not be divulged to a third party unless written permission is first obtained from BÖRNER technical services department. The drawing is valid only when approved by the Architect / Contractor concerned.

This detail is representative of a typical situation and provided for illustration purposes. Insulation thickness shown may differ in accordance with specifiers U value requirement.