

CHANGE IN LEVEL

Option 1

Apply an insulation stop batten to the top edge of the upper level (100mm wide & 30mm thinner than insulation thickness, so as to prevent lap build up) being mechanically fixed to the roof deck, to provide a hard edge to all steps.

Fix 18mm plywood capping piece to oversail stop batten & cover top edge of vertical insulation.

Apply sufficient coats of the specified BÖRNER Prime Coating to the detail.

Apply the specified BÖRNER Vapour Control Layer to the primed area as indicated, providing an additional piece of VCL to dress onto the insulation stop & link with the Underlayer by 50mm minimum.

Apply the specified PIR Insulation to the Vapour Control Layer, including vertically, to be bonded as per BÖRNER Specification Proposal.

Provide 50mm x 50mm specified BÖRNER Angle Fillets to the junction of all horizontal & vertical abutments

Apply the specified waterproofing detailing fully bonded to the detail as indicated. Detailing Underlayer and Cap Sheet must be returned to the inner edge of the insulation stop batten and lapped and fully sealed onto the main area as indicated.

Option 2

Apply sufficient coats of the specified BÖRNER Prime Coating to the detail.

Apply the specified BÖRNER Control Layer to the change in level as indicated.

Apply the specified 120mm Torch Receivable PIR Insulation to the Vapour Control Layer, including vertically, to be bonded as per BÖRNER Specification Proposal.

Provide 50mm x 50mm BÖRNER Angle Fillets to the junction of all horizontal & vertical abutments

Apply a galvanised metal angle minimum 150mm x 150mm, bonded in PU Adhesive to protect the exposed corner of the insulation.

Apply the specified waterproofing detailing fully bonded to the detail as indicated. Detailing Underlayer and Cap Sheet must be lapped and fully sealed onto the main area as indicated.

NOTES:

All details to be installed in accordance with BS8217, BS6229, and BÖRNER recommendations.

All waterproofing detailing must be undertaken as two layers and as separate items.

All surfaces must be clean, dry, and suitably prepared to accept the waterproofing system.

During the application of all bitumen membranes a visible bead of bitumen must be exuded from all side and end laps.

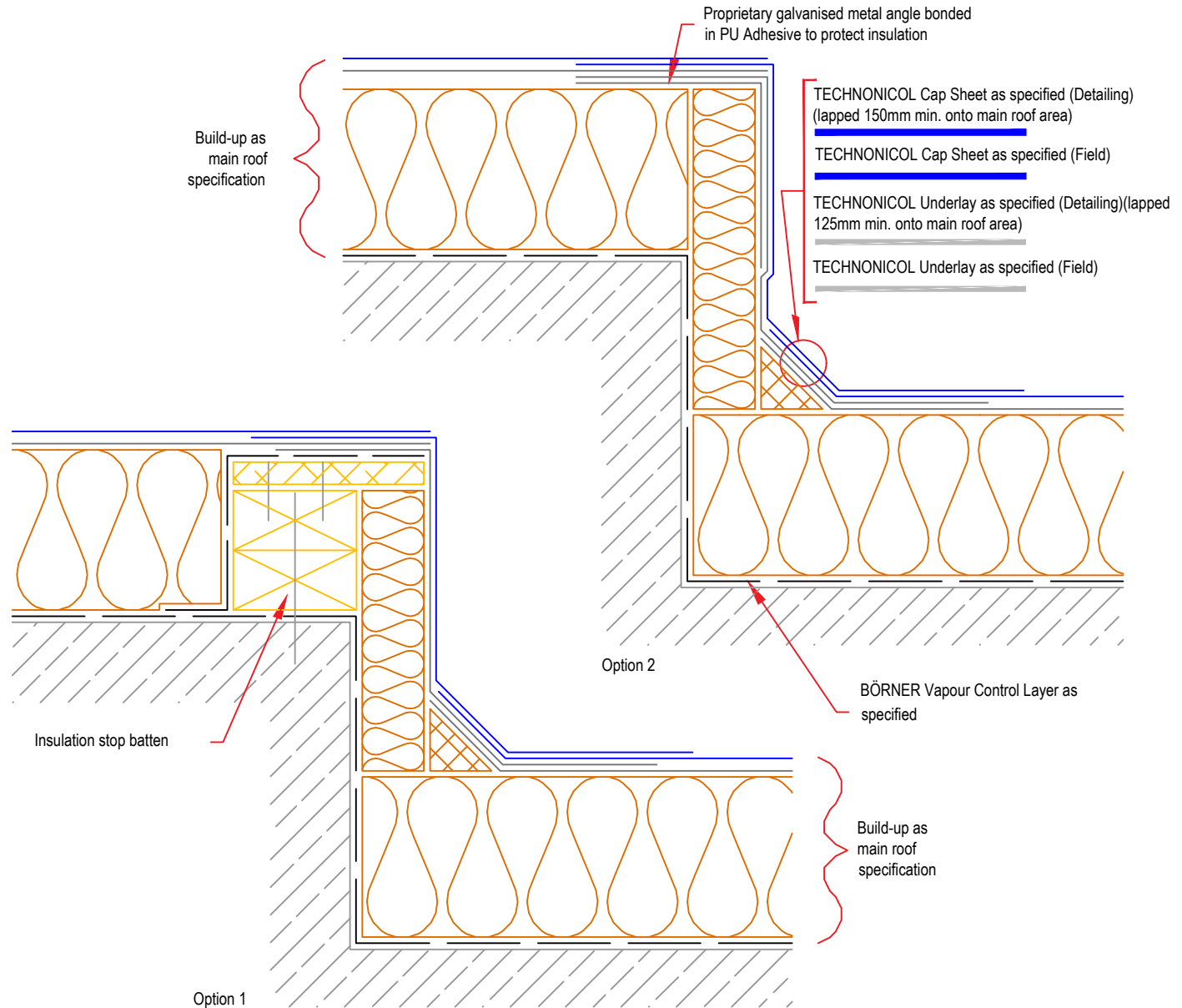

Standard  
Detail

Drawing Title:

Change in Level

Date:  
2018

Notes / Revisions:

Drawing No.

G1

Scale:  
NTS

Drawn By:  
BÖRNER



BÖRNER. Systematically sealed.

Email: info@borner.ie

Copyright Reserved - Please note that this drawing & the copyright therein is the property of BÖRNER & is issued on the understanding that the drawing or any detail thereof will not be divulged to a third party unless written permission is first obtained from BÖRNER technical services department. The drawing is valid only when approved by the Architect / Contractor concerned.

This detail is representative of a typical situation and provided for illustration purposes. Insulation thickness shown may differ in accordance with specifiers U value requirement.