

PIPE PENETRATIONS - Pipe & Cable Entry

Apply Insulated Hard Edge or treated timber stop batten mechanically fastened, or adhered in BÖRNER PU ADHESIVE (internal use of hard edge only) to the roof deck to provide a hard edge as indicated.

Apply sufficient coats of the specified BÖRNERBÖRNERG to the detail.

Apply the specified BÖRNER Vapour Control Layer to the primed substrate & dressed to link with the Underlayer by 50mm minimum.

Apply the specified PIR Insulation to the Vapour Control Layer, to be bonded as per BÖRNER Specification Proposal.

Apply the specified BÖRNER Underlay (Field) fully bonded and dressed to link with the Vapour Control Layer as indicated.

Apply pipe & cable penetration base unit mechanically fixed to the timber stops as per manufacturer's recommendations. Prime the flange of the unit with the specified primer.

Apply the specified BÖRNER Cap Sheet (Field) as indicated, followed by the Detailing Cap Sheet fully bonded to the detail, sealed onto the flange, lapped and fully sealed to the main roof area as indicated.

Ensure the detachable lid is fitted to the top of the unit as per the manufacturer's recommendations.

NOTES:

All details to be installed in accordance with BS8217, BS6229, and BÖRNER recommendations.

All waterproofing detailing must be undertaken as two layers and as separate items.

All surfaces must be clean, dry, and suitably prepared to accept the waterproofing system.

During the application of all bitumen membranes a visible bead of bitumen must be exuded from all side and end laps.

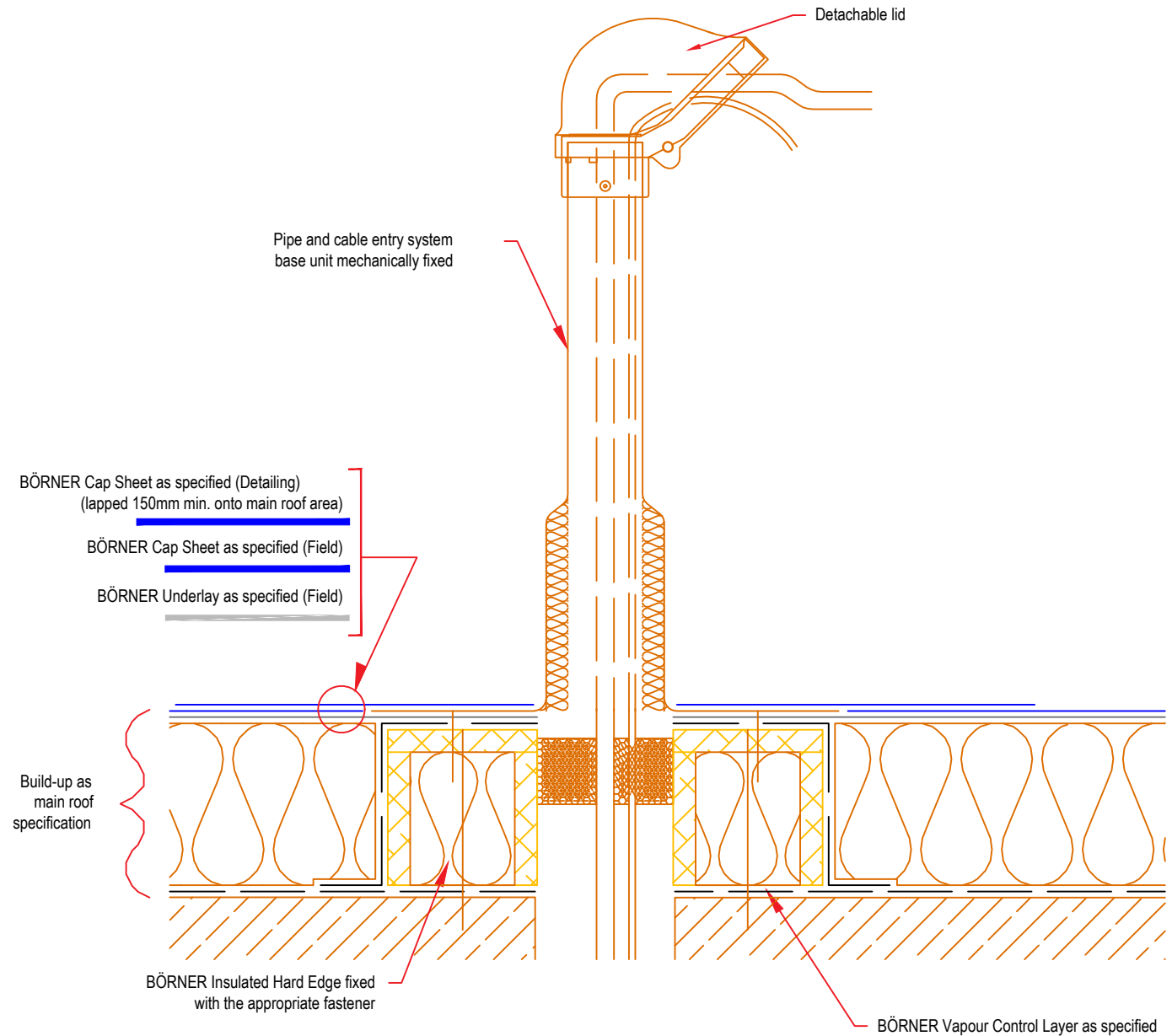

Copyright Reserved - Please note that this drawing & the copyright therein is the property of BÖRNER & is issued on the understanding that the drawing or any detail thereof will not be divulged to a third party unless written permission is first obtained from BÖRNER technical services department. The drawing is valid only when approved by the Architect / Contractor concerned.

This detail is representative of a typical situation and provided for illustration purposes. Insulation thickness shown may differ in accordance with specifiers U value requirement.

**Standard
Detail**

Drawing Title:

Pipe Penetrations - Pipe & Cable Entry

Date:
2018

Notes / Revisions:

Drawing No.

F5

Scale:
NTS

Drawn By:
BÖRNER



BÖRNER. Systematically sealed.

Email: info@borner.ie