

## DRIP TO GUTTER

Apply Insulated Hard Edge or treated timber stop batten (100mm wide & 10mm thinner than the insulation, so as to prevent lap build up) mechanically fastened to the roof deck to provide a hard edge to all perimeters.

Where an additional insulation thickness is specified the perimeter will need to be raised to accommodate the new detail in accordance with BÖRNER Technical Services recommendations. This may affect the aesthetics of the external facade, so allowance must be made for raising the existing facade & associated components, e.g. fascia boards, guttering.

Apply & securely fix a 50mm x 38mm minimum treated timber batten.

Apply sufficient coats of the specified BÖRNER PRIME COATING to the detail.

Apply the specified BÖRNER Vapour Control Layer to the primed substrate & dressed to link with the Underlayer by 50mm minimum.

Apply the specified PIR Insulation to the Vapour Control Layer, to be bonded as per BÖRNER Specification Proposal.

Apply the specified BÖRNER Underlay fully bonded and dressed to link with the Vapour Control Layer as indicated.

Install felt drips using 75mm (minimum) x 6mm plywood drip former, mechanically fastened to the treated welted drip batten. Form welted drip in the specified Cap Sheet to outer edge, lapped and fully sealed onto the main area as indicated. Apply Field Area Cap Sheet.

### NOTES:

All details to be installed in accordance with BS8217, BS6229, and BÖRNER recommendations.

All waterproofing detailing must be undertaken as two layers and as separate items.

All surfaces must be clean, dry, and suitably prepared to accept the waterproofing system.

During the application of all bitumen membranes a visible bead of bitumen must be exuded from all side and end laps.

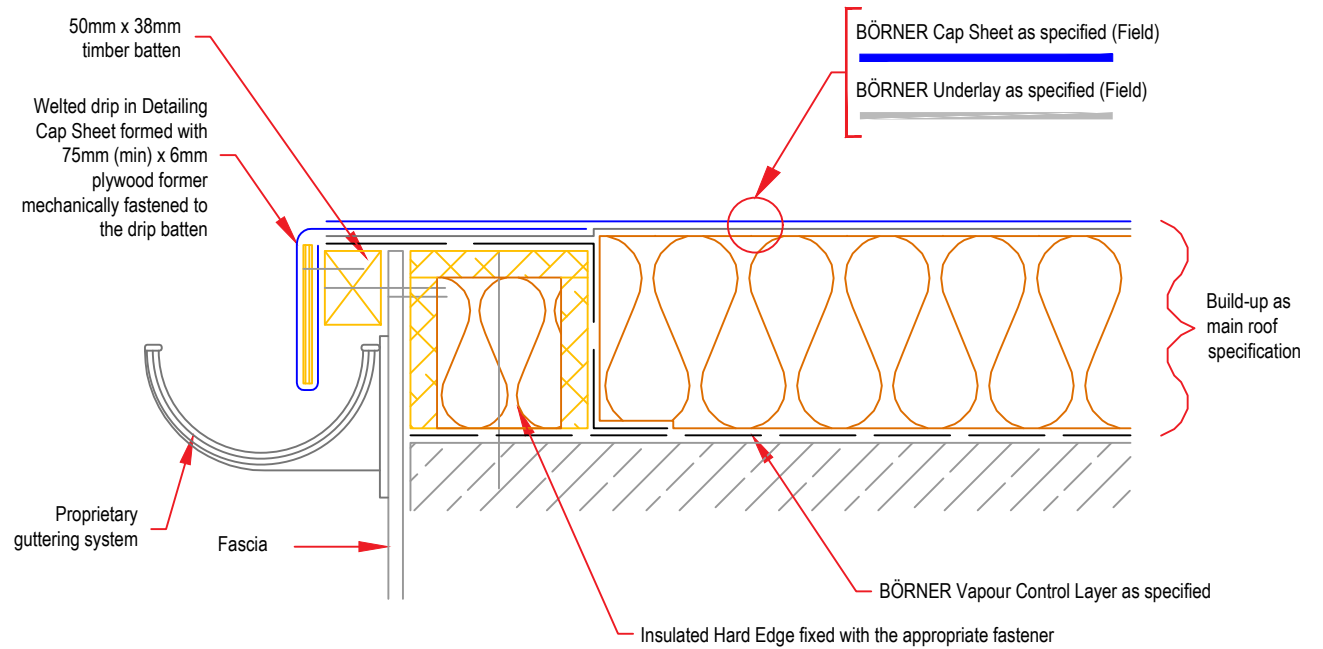

Copyright Reserved - Please note that this drawing & the copyright therein is the property of BÖRNER & is issued on the understanding that the drawing or any detail thereof will not be divulged to a third party unless written permission is first obtained from BÖRNER technical services department. The drawing is valid only when approved by the Architect / Contractor concerned.

This detail is representative of a typical situation and provided for illustration purposes. Insulation thickness shown may differ in accordance with specifiers U value requirement.

# Standard Detail

Drawing Title:

Drip to Gutter

Date:  
2018

Notes / Revisions:

Drawing No.

E1

Scale:  
NTS

Drawn By:  
BÖRNER



BÖRNER. Systematically sealed.

Email: [info@borner.ie](mailto:info@borner.ie)