

CHECK KERB - Timber - GRP Trim

Raise open perimeter check kerb, using treated timber, to give an upstand height of 40mm above the surface of the completed waterproofing and provide an insulation stop. Inner face of kerb to be chamfered to a 45° angle, using either profiled timber or tilt Fillets.

When raising perimeter check kerbs, consideration must be given to the external appearance of the building & the potential requirement for fascia boards or trims with increased depth & or additional cladding sections to be used. It is suggested that guidance is sought from the client & allowance made for this aspect prior to commencing the contract.

Apply sufficient coats of the specified BÖRNER Prime Coating to the detail.

Apply the specified BÖRNER Vapour Control Layer to the primed upstand & dressed to link with the Underlayer by 50mm minimum.

Apply the specified PIR Insulation to the Vapour Control Layer, to be bonded as per BÖRNER Specification Proposal.

Apply the specified waterproofing detailing fully bonded to the detail, lapped and fully sealed onto the main area as indicated. The specified BÖRNER Underlay should be finished so as to drape over the outer edge as shown.

Apply GRP Edge Trim, mechanically fastened to the timber capping at 300mm centres maximum (150mm maximum for areas of high wind uplift) and sandwiched between waterproofing layers as indicated. Apply the specified BÖRNER Cap Sheet fully bonded to the detail, dressed into the channel of the GRP Edge Trim, lapped and fully sealed onto the main roof area as indicated.

NOTES:

All details to be installed in accordance with BS8217, BS6229, and BÖRNER recommendations. All

waterproofing detailing must be undertaken as two layers and as separate items.

All surfaces must be clean, dry, and suitably prepared to accept the waterproofing system.

During the application of all bitumen membranes a visible bead of bitumen must be exuded from all side and end laps.

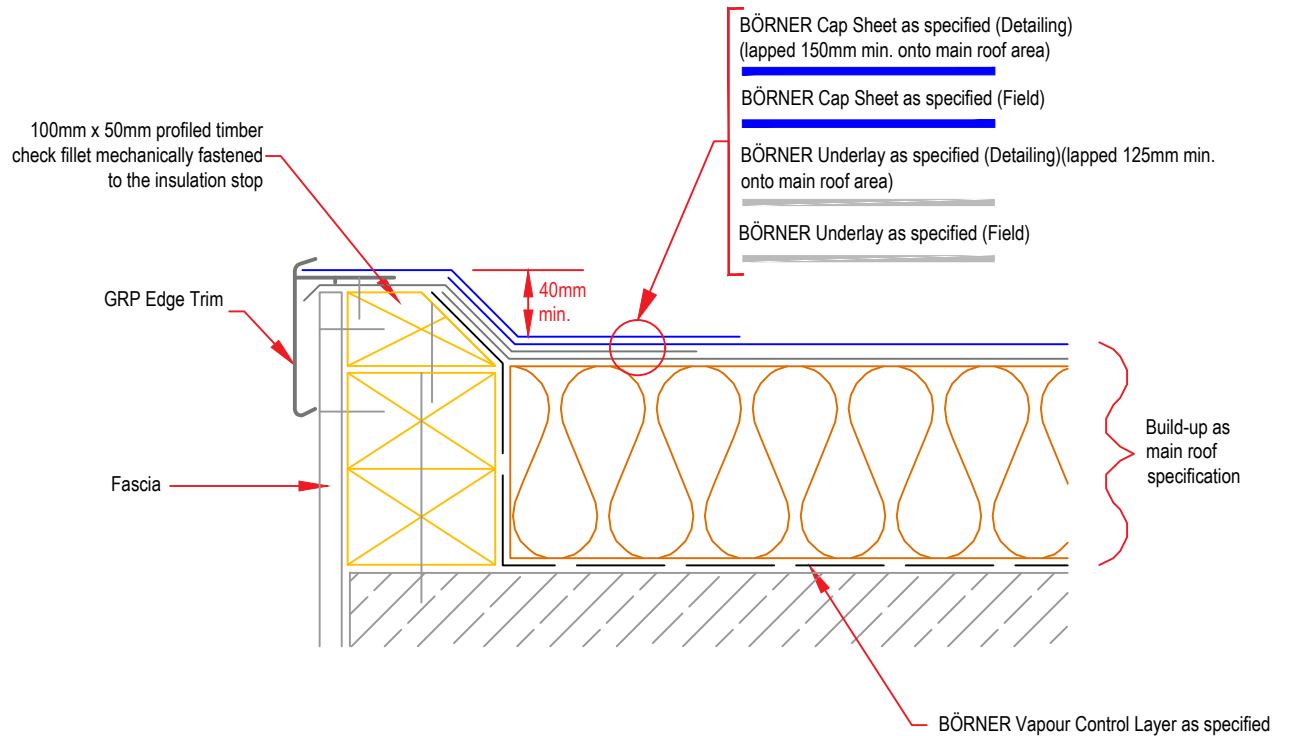

Copyright Reserved - Please note that this drawing & the copyright therein is the property of BÖRNER & is issued on the understanding that the drawing or any detail thereof will not be divulged to a third party unless written permission is first obtained from BÖRNER technical services department. The drawing is valid only when approved by the Architect / Contractor concerned.

This detail is representative of a typical situation and provided for illustration purposes. Insulation thickness shown may differ in accordance with specifiers U value requirement.

**Standard  
Detail**

Drawing Title:

Check Kerb - Timber - GRP Trim

Date:  
2018

Notes / Revisions:

Scale:  
NTS

Drawing No.

C3

Drawn By:  
BÖRNER



BÖRNER. Systematically sealed.

Email: info@borner.ie