

SKIRTING TO ROOFLIGHT - New Proprietary Kerb

Existing rooflights should be assumed to be fragile & all appropriate measures taken to prevent people falling through them. The Contractor for the works is required to provide a Risk Assessment & Method Statement for the safe working of personnel around rooflights.

Remove the existing rooflight cover unit & kerb & dispose off site.

Any exposed openings must be protected against objects/personnel falling through.

Apply the specified new rooflight kerb being mechanically fixed to the deck/timber kerb in strict accordance with the manufacturers recommendations.

Apply sufficient coats of the specified BÖRNER PRIME COATING to the detail.

Apply the specified BÖRNER Vapour Control Layer to the primed upstand & dressed to link with the Underlayer by 50mm minimum.

Apply the specified PIR Insulation to the Vapour Control Layer, to be bonded as per BÖRNER Specification Proposal.

Apply the specified waterproofing detailing fully bonded to the rooflight kerb. Detailing Underlayer and Cap Sheet must be lapped and fully sealed onto the main area as indicated.

Certain rooflight assemblies may include a dedicated termination detail to ensure that the waterproofing is fully fixed & protected.

Fix the rooflight dome in accordance with manufacturers guidance.

Allowance should be made for making good any interior decoration, where the unit has been raised to accommodate the detail.

NOTES:

All details to be installed in accordance with BS8217, BS6229, and BÖRNER recommendations.

Completed waterproofing upstand details should always be installed so as to achieve a height of 150mm minimum above the finished roof level.

All waterproofing detailing must be undertaken as two layers and as separate items.

All surfaces must be clean, dry, and suitably prepared to accept the waterproofing system.

During the application of all bitumen membranes a visible bead of bitumen must be exuded from all side and end laps.

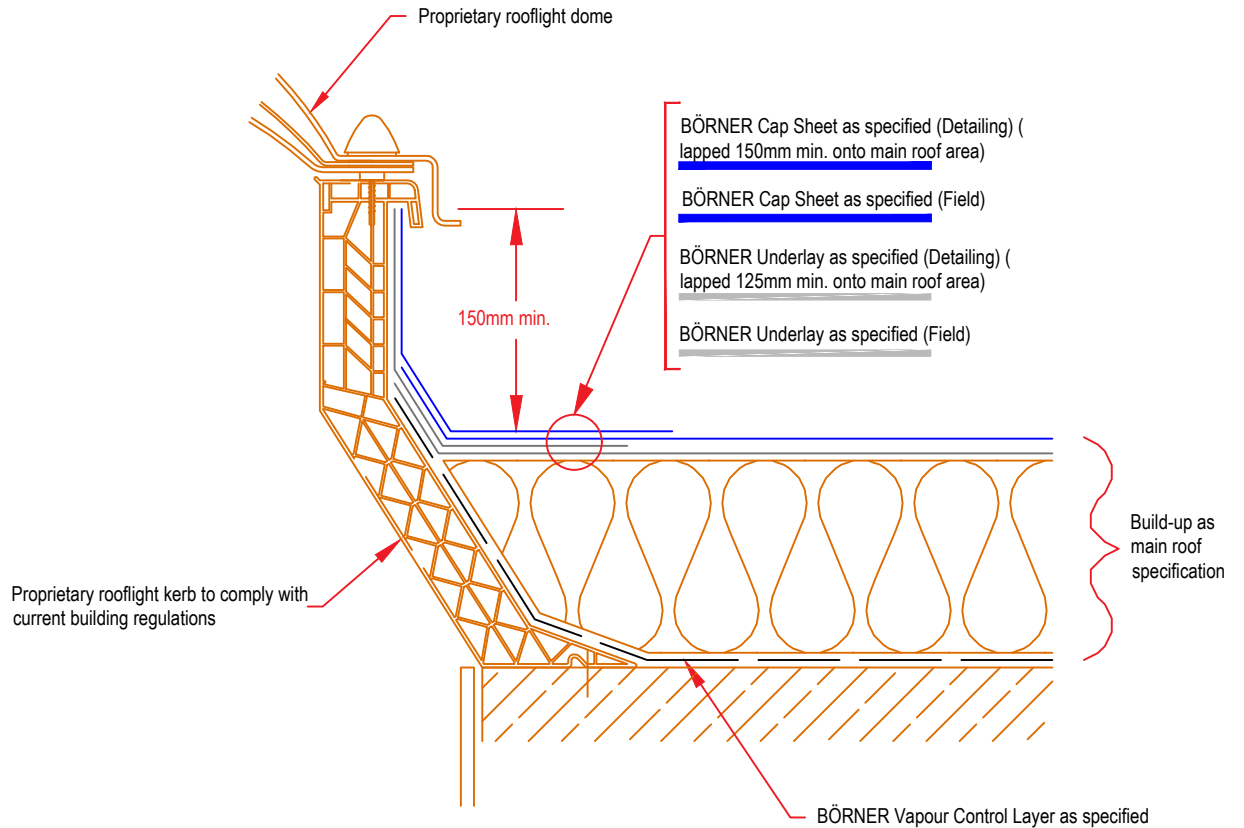

Standard
Detail

Drawing Title:

Skirting to Rooflight - New Proprietary Kerb

Date:
2018

Notes / Revisions:

Drawing No.

B14

Scale:
NTS

Drawn By:
BÖRNER



BÖRNER. Systematically sealed.

Email: info@borner.ie

Copyright Reserved - Please note that this drawing & the copyright therein is the property of BÖRNER & is issued on the understanding that the drawing or any detail thereof will not be divulged to a third party unless written permission is first obtained from BÖRNER technical services department. The drawing is valid only when approved by the Architect / Contractor concerned.

This detail is representative of a typical situation and provided for illustration purposes. Insulation thickness shown may differ in accordance with specifiers U value requirement.