

**SKIRTING TO UPSTAND - Vertical Slates/Tiles**

Apply sufficient coats of the specified BÖRNER PRIME COATING to the detail.

Apply the specified BÖRNER Vapour Control Layer to the primed upstand & dressed to link with the Underlayer by 50mm minimum.

Apply the specified PIR Insulation to the Vapour Control Layer, to be bonded as per BÖRNER Specification Proposal.

Provide 50mm x 50mm specified BÖRNER Angle Fillets to the junction of all horizontal & vertical abutments

Apply the specified waterproofing detailing fully bonded to the upstand. Detailing Underlayer and Cap Sheet must be lapped and fully sealed onto the main area as indicated.

Ensure that any existing vertical breather or waterproof membrane behind the tiles/slates is correctly dressed & undamaged; any damaged membrane should be replaced with new to match the existing.

Re-fix the battens & tiles/slates, providing an additional flashing using lead-free flashing secured behind the tiles/slates as indicated to provide a minimum 75mm cover to the new waterproofing.

**NOTES:**

Where torch applied abutment details are deemed to be inappropriate following the Client/ Contractor's Risk Assessment for the works, BÖRNER recommend that materials designed to be installed by using flame-free application techniques are used.

Completed waterproofing upstand details should always be installed so as to achieve a height of 150mm minimum above the finished roof level.

All details to be installed in accordance with BS8217, BS6229, and BÖRNER recommendations.

All waterproofing detailing must be undertaken as two layers and as separate items.

All surfaces must be clean, dry, and suitably prepared to accept the waterproofing system.

During the application of all bitumen membranes a visible bead of bitumen must be exuded from all side and end laps.

Any upstands in excess of 250mm should be mechanically fixed at the leading edge with appropriate fasteners in order to avoid slippage of the waterproofing membrane.

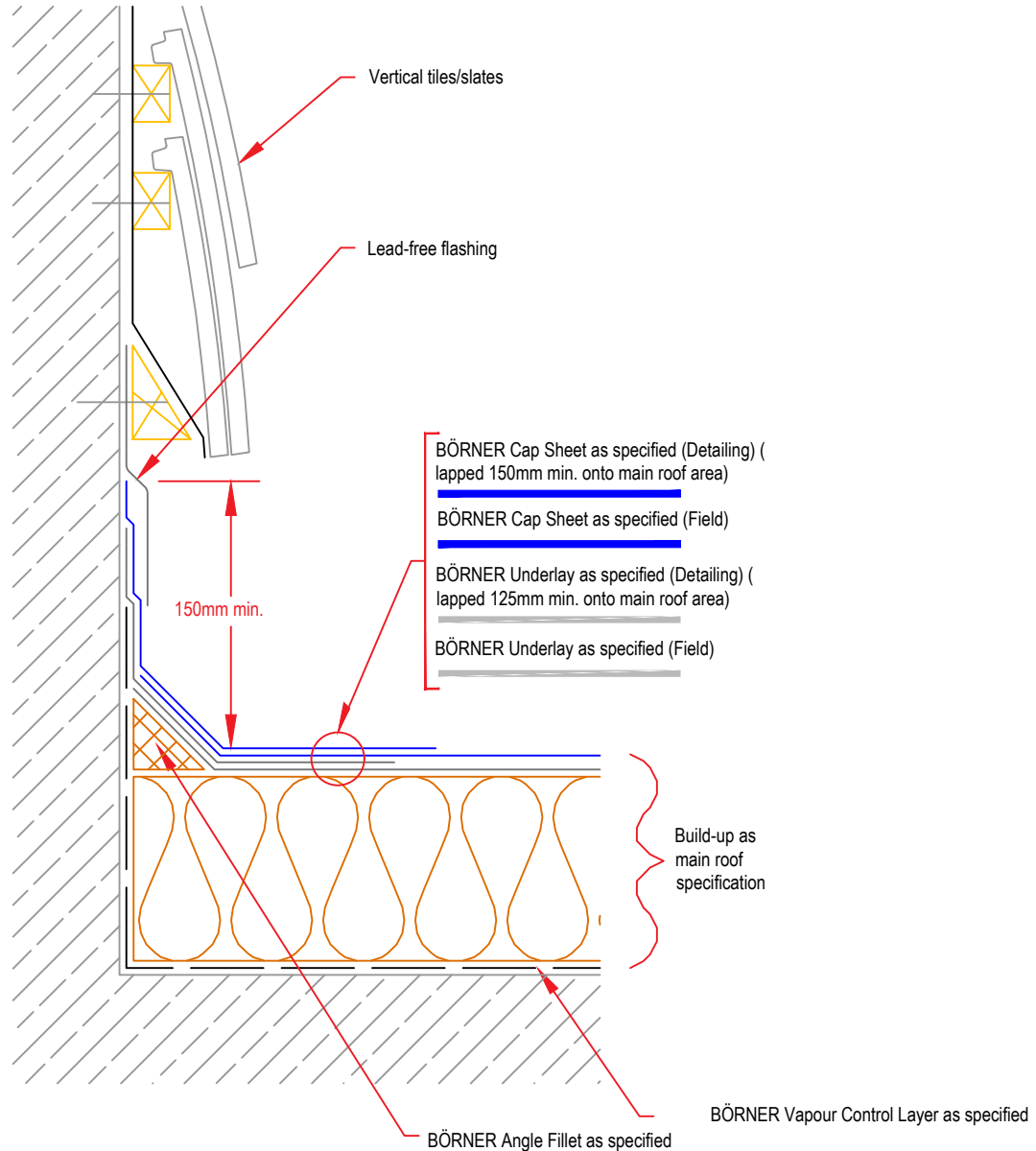

Copyright Reserved - Please note that this drawing & the copyright therein is the property of BÖRNER & is issued on the understanding that the drawing or any detail thereof will not be divulged to a third party unless written permission is first obtained from BÖRNER technical services department. The drawing is valid only when approved by the Architect / Contractor concerned.

This detail is representative of a typical situation and provided for illustration purposes. Insulation thickness shown may differ in accordance with specifiers U value requirement.

**Standard  
Detail**

Drawing Title:

**Skirting to Upstand - Vertical Slates / Tiles**

Date:  
2018

Notes / Revisions:

Drawing No.

**B12**

Scale:  
NTS

Drawn By:  
BÖRNER



BÖRNER. Systematically sealed.

Email: info@borner.ie