

SKIRTING TO UPSTAND - Door Cill - NHBC Accessible Threshold

Apply sufficient coats of the specified BÖRNER PRIME COATING to the detail.

Apply the specified BÖRNER Vapour Control Layer to the primed upstand & dressed to link with the Underlayer by 50mm minimum.

Apply the specified PIR Insulation to the Vapour Control Layer, to be bonded as per BÖRNER Specification Proposal.

Provide 50mm x 50mm specified BÖRNER Angle Fillets to the junction of all horizontal & vertical abutments

Apply the specified waterproofing detailing fully bonded to the upstand and taking the waterproofing underneath the new cill as indicated. The specified BÖRNER Underlay and Cap Sheet must be lapped and fully sealed onto the main area as indicated.

Provide suitable decking or paving on suitable supports to provide an accessible threshold, ensuring the new waterproofing is adequately protected. The supports used to raise the decking or paving must not restrict the flow of water to the drainage system. To ensure adequate drainage minimum 10mm gaps should be provided between individual units of decking or paving and the cill, perimeter walls and kerbs.

NOTES:

This detail should follow NHBC guidance for a min 75mm upstand to door cill detail. The cill detail must be at the highest point with positive falls to an outlet or drainage chute. An additional overflow must be provided at the lowest point to be a minimum of 25mm below the underside of the door cill. The cill must project a minimum of 45mm to shed rainwater away from the interface with the waterproofing layer. A minimum 150mm waterproofing upstand above the finished surface must be provided at all perimeter wall details to maintain a minimum 150mm splash zone. Decking or paving should be provided on suitable drained supports to provide an accessible threshold.

All details to be installed in accordance with BS8217, BS6229, and BÖRNER recommendations.

All waterproofing detailing must be undertaken as two layers and as separate items.

All surfaces must be clean, dry, and suitably prepared to accept the waterproofing system.

During the application of all bitumen membranes a visible bead of bitumen must be exuded from all side and end laps.

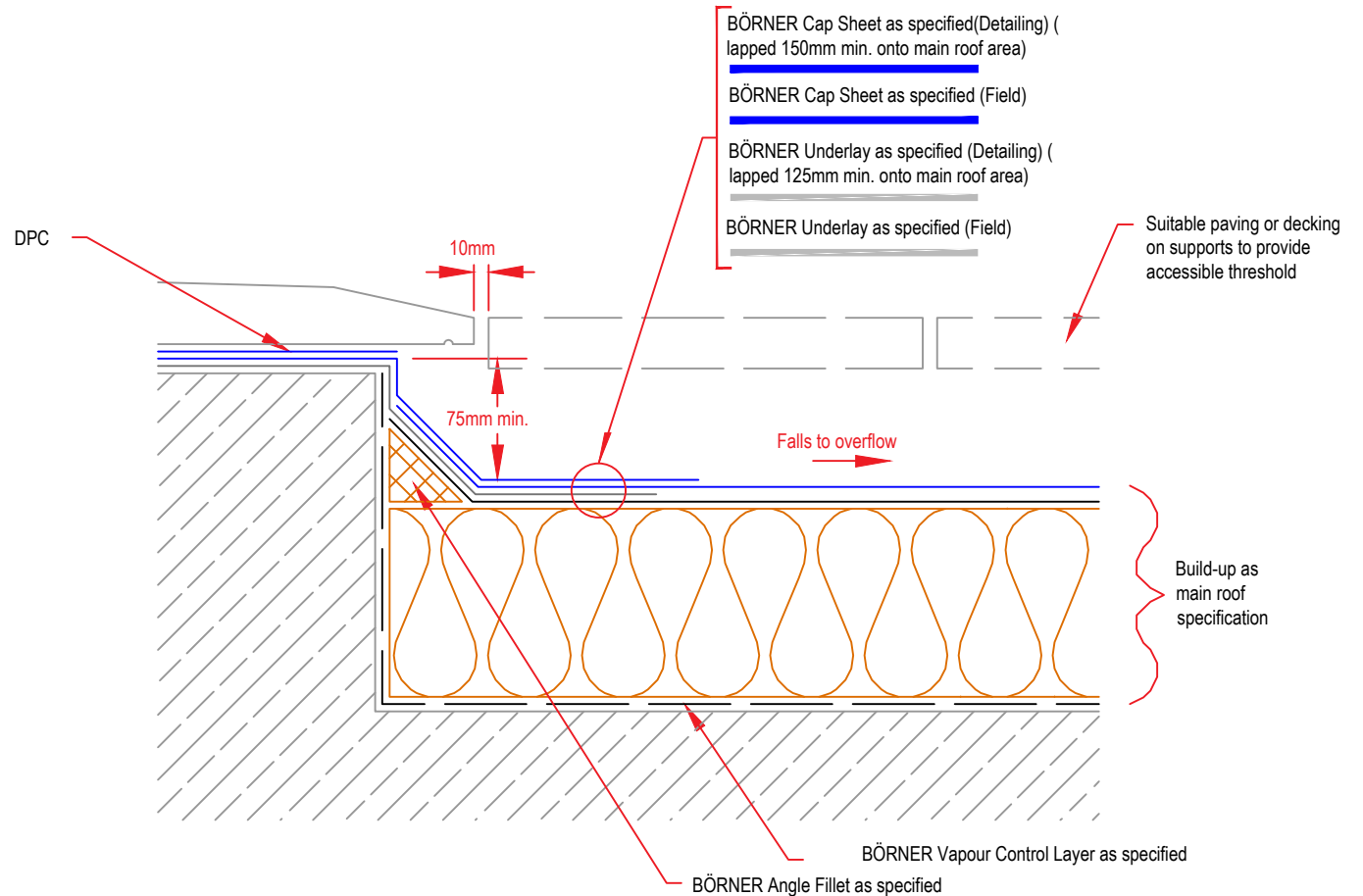

Standard
Detail

Drawing Title:

Skirting to Upstand - Door Cill - NHBC Accessible Threshold

Date:
2018

Notes / Revisions:

Scale:
NTS

Drawing No.

B7

Drawn By:
BÖRNER



BÖRNER. Systematically sealed.

Email: info@borner.ie

Copyright Reserved - Please note that this drawing & the copyright therein is the property of BÖRNER & is issued on the understanding that the drawing or any detail thereof will not be divulged to a third party unless written permission is first obtained from BÖRNER technical services department. The drawing is valid only when approved by the Architect / Contractor concerned.

This detail is representative of a typical situation and provided for illustration purposes. Insulation thickness shown may differ in accordance with specifiers U value requirement.