

WATERPROOFING TO PARAPET - GRP trim

Remove any cavity tray from within the parapet, which directs water internally to the roof area. Care should be taken not to bridge over any DPC/Cavity tray when installing the new waterproofing system. Inspect and carry out any maintenance work to the parapet as necessary.

Apply an 18mm OSB/3 or plywood panel, to the top of the parapet, over a loose laid DPC and to the vertical face of the parapet secured by mechanical fixings.

Apply sufficient coats of the specified BÖRNER PRIME COATING to the detail.

Apply the specified BÖRNER Vapour Control Layer to the primed upstand & dressed to link with the Underlayer by 50mm minimum.

Apply the specified PIR Insulation to the Vapour Control Layer, to be bonded as per BÖRNER Specification Proposal.

Provide 50mm x 50mm specified BÖRNER Angle Fillets to the junction of all horizontal & vertical abutments.

Apply the specified waterproofing detailing fully bonded to the vertical and horizontal surfaces of the parapet, lapped and fully sealed onto the main area as indicated. The specified BÖRNER Underlay (Detailing) should be finished so as to drape over the outer edge as shown.

Apply GRP edge trim, mechanically fastened to the timber capping at 300mm centres maximum (150mm maximum for areas of high wind uplift) and sandwiched between waterproofing layers as indicated.

Apply the specified BÖRNER Cap Sheet (Detailing) fully bonded to the vertical and horizontal surfaces of the parapet, dressed into the channel of the GRP edge trim, lapped and fully sealed onto the main roof area as indicated.

NOTES:

Where torch applied abutment details are deemed to be inappropriate following the Client/Contractor's Risk Assessment for the works, BÖRNER recommend that materials designed to be installed by using flame-free application techniques are used.

All details to be installed in accordance with BS8217, BS6229, and BÖRNER recommendations.

All waterproofing detailing must be undertaken as two layers and as separate items.

All surfaces must be clean, dry, and suitably prepared to accept the waterproofing system.

During the application of all bitumen membranes a visible bead of bitumen must be exuded from all side and end laps.

Any upstands in excess of 250mm should be mechanically fixed at the leading edge with appropriate fasteners in order to avoid slippage of the waterproofing membrane.

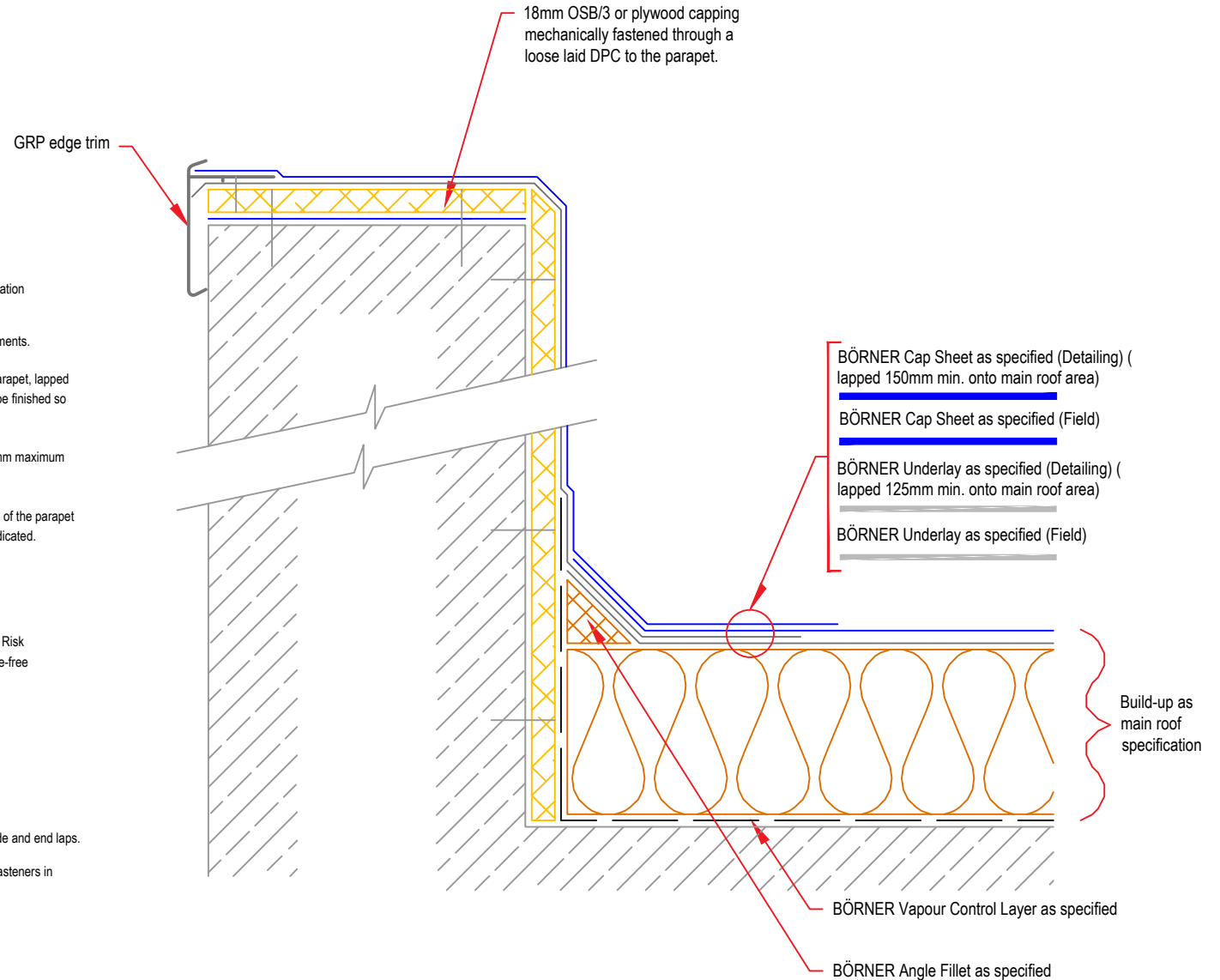

Copyright Reserved - Please note that this drawing & the copyright therein is the property of BÖRNER & is issued on the understanding that the drawing or any detail thereof will not be divulged to a third party unless written permission is first obtained from BÖRNER technical services department. The drawing is valid only when approved by the Architect / Contractor concerned.

This detail is representative of a typical situation and provided for illustration purposes. Insulation thickness shown may differ in accordance with specifiers U value requirement.

Standard
Detail

Drawing Title:

Waterproofing to Parapet - GRP Trim

Date:
2018

Notes / Revisions:

Drawing No.

A3

Scale:
NTS

Drawn By:
BÖRNER



BÖRNER. Systematically sealed.

Email: info@borner.ie